

## How to Project - From a Flip Video Camera

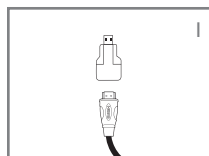

1  
Connect the Micro-HDMI convertor to the Mini-HDMI cable (if needed)

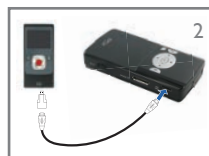

2  
Connect the Flip video camera to the projector



3  
Turn the Flip video camera on



4  
Turn the projector on



5  
Press the Search Inputs Button



6  
Press Play on the Flip video camera

**Note:** Connecting the Flip video camera to the projector is for playback mode only. The screen of the Flip video camera will turn off once connected to the projector. Select and play videos on the Flip video camera as usual.

## Customer Support

If you have any questions about your UP-2020 Pocket Projector please contact the iGo support team Monday-Friday 7:00am through 7:00pm (MST). By Phone: 1-888-948-9144 or Email: support@igo.com.

## Troubleshooting

- The HDMI cable needs to plug fully into the projector (with a click).
- The display screen on many devices will turn off when connected to the projector.
- Some smartphones will display photos in slideshow mode only.
- Most smartphones and digital cameras will only send videos or photos to the projector; they will not project your screen image.
- If your videos will not display, ensure they are MPEG4 files.

## Limited Warranty

This Limited Warranty is extended by iGo, Inc. to the original purchaser of the Pocket Projector UP-2020 ("Product") and is not transferable. iGo Inc. warrants the product against defects in materials and workmanship under normal use for a period of ONE (1) Year from the date of original purchase and Three (3) Months on the battery. If the Product becomes defective during its warranty period, iGo Inc. will, at its option, repair or replace the Product with new or reconditioned components or parts. If the Product purchased is a refurbished unit, the warranty period will depend on the terms for that particular unit, which are described in the refurbished unit's warranty card. The period may vary anywhere from "Sale as is" to "90 Day Limited Warranty" to "Two Year Limited Warranty".

### WHAT IS NOT COVERED

This warranty does not cover and shall be voided by defects or damage resulting from the following: natural or man-made occurrences or disasters including, but not limited to earthquakes, fires, floods, power surges, storms, casualties, accidents, misuse, abuse, neglect, alterations, or service or repair by entities other than Authorized iGo Inc. Service Providers. iGo Inc. and its Service Providers are not responsible for damages or loss incurred during the shipping process.

### OBTAINING WARRANTY SERVICE

Should your Product prove defective during the warranty period and is within the LIMITED WARRANTY, please contact iGo product support and service. If the Product is eligible for warranty service, the original purchaser (customer) will be issued a Return Merchandise Authorization (RMA) number and given shipping instructions. Please include proof of the date of original purchase (invoice) or proof of warranty registration with the shipment. Postage, insurance and shipping costs incurred in returning your Product to iGo Inc. or authorized service provider for warranty service is the customer's responsibility. iGo Inc. and its Service Providers are not responsible for any loss or damage to the Product while the Product is in transport to or from iGo Inc. or its Service Provider. A Product returned for warranty service must be shipped complete in its original packaging material or equivalent to avoid damage while in transit. Please visit our website [www.igo.com](http://www.igo.com) for further details and instructions.

**Online Registration:** Receive one additional year of warranty coverage plus special member-only offers when you register your product at [www.iGo.com/register](http://www.iGo.com/register). Registration helps us serve you better; failure to register does not diminish your warranty rights.

© 2002-2010 iGo, Inc. iGo is a registered trademark of iGo, Inc. Flip Video, UltraHD, MinoHD, SlideHD, and the Designed for Flip Video badge are registered trademarks of Cisco. All other brand names and logos are trademarks of their respective owners. Specifications are subject to change without notice. P/NAC05050-0002 Rev.A

# iGo®

## Quick Start Guide



Pocket Projector UP-2020



- |                                  |                                   |
|----------------------------------|-----------------------------------|
| 1. Focus Dial                    | 10. Audio Out Connector           |
| 2. VGA/Component Input Connector | 11. AV Input Connector            |
| 3. Mini HDMI Connector           | 12. MicroSD Card Slot             |
| 4. Battery Indicator             | 13. Micro USB port                |
| 5. Menu / Esc Button             | 14. Screw Hole for Tripod         |
| 6. Enter Button                  | 15. Power Input                   |
| 7. Power Button                  | 16. Mini- to Micro-HDMI converter |
| 8. Search Inputs Button          | 17. Mini-HDMI Cable               |
| 9. Navigation / Volume Pad       |                                   |

## Getting Started

### Insert the Battery

a. Remove the cover      b. Insert battery

### Charge the Battery

## How to Project - From a Device

### 1. HDMI

(e.g. Flip video cameras, smartphones)

1. Connect the HDMI Cable or the the HDMI cable and micro HDMI converter (if needed) to the device and projector
2. Turn projector on
3. Start videos or photo slideshow on device
4. Press the Search Inputs Button

### 2. VGA Cable

(e.g. laptops)

1. Connect the VGA Cable to the laptop and projector
2. Turn projector on
3. Start video or photo slideshow on device
4. Press the Search Inputs Button

### 3. AV Input Cable

(e.g. devices without HDMI)

1. Connect the AV Input Cable to the device and projector
2. Turn projector on
3. Start videos or photo slideshow on device
4. Press the Search Inputs Button

## How to Project - From an SD Card

### MicroSD Card

1. Insert MicroSD Card
2. Power on projector
3. Navigate menu to (Figure 1) by using navigation pad
4. Press Enter button
5. Choose Photo (Figure 2) or Video (Figure 3)
6. Press Enter button
7. Select photo or video from list
8. Press Enter button to play



Figure 1



Figure 2



Figure 3