

Philips Screeneo
Screeneo Smart LED
Projector

HDP1690



Get the big picture

Enjoy big entertainment - an image from 50" up to a 100" with Screeneo placed just a few centimeters from the wall. Easy to move it around in the house or simply set-up your outdoor cinema in the garden! Features also great sound and Wi-Fi!

From small to big with excellent image quality

- Flexible screen size - from 50 - 100"
- LED technology for brilliant colours and long life

Enrich your sound experience

- Integrated speakers and subwoofer
- Stream your music via Bluetooth or Wi-Fi / DLNA

Content from anywhere

- Connect wired or wireless - it's up to you!
- Miracast - share your content instantly



PHILIPS

Highlights

Connect wired or wireless

With the built-in Wi-Fi you can easily connect to the world online or to your network at home via DLNA or Bluetooth and project your content from these devices. If you prefer physical media you can connect the Screeneo via HDMI, insert an SD card into the card reader, connect a USB flash, or connect the antenna to an antenna jack.

Flexible screen size

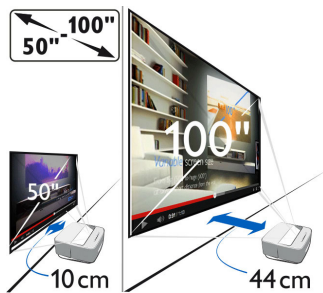

Experience your movies, sport events or gaming like you have never done before, from 50" up to 100". Lean back and enjoy, in the comfort of any

room in your home. Screeneo can easily be placed close to any smooth wall. You just need to grab the stylish leather handle at the back of the product. For viewing a cartoon film for kids on a 50", place it 10 cm from the wall, for your favourite football match on 100", place Screeneo 44 cm far from the wall.

Integrated speakers

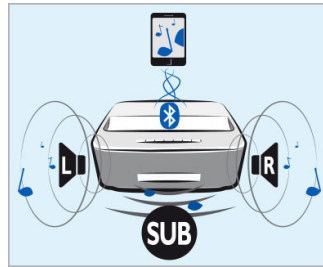

There is no need to connect to any sound system, thanks to the integrated subwoofer and loudspeakers, with an output power of 26W RMS. Your perfect sound experience will be completed with Dolby Digital 2.1 sound system.

LED technology

Screeneo uses high quality LED technology to project your photos, movies and more in brilliant colours and a duration of 30,000 hours. Combined with the innovative ultra short throw technology, it guarantees a big wow anytime you switch it on.

Miracast

It sounds elaborate, but it's so simple: While browsing photos on your smartphone or tablet, connect wirelessly with Screeneo, which mirrors your screen instantly. Whatever you do on your handheld device is projected wirelessly using Miracast.

Stream your music

Use Screeneo as a Music station! Stream conveniently music from your smartphone or tablet to Screeneo via Bluetooth or DLNA (Digital Living Network Alliance) functionality.

Specifications

Technology/ optical

- Aspect ratio: 4:3 and 16:9
- Contrast ratio: 100.000:1
- Display technology: DLP
- Focus adjustment: manual
- Internal memory: 4 GB
- Keystone correction
- LED light source lasts over: 30.000 hours
- Light source: RGB LED
- MP4 player
- Noise level: < 25 dB(A)
- Operating system: Android 4.2
- Resolution: 1280 x 800 pixel
- Screen distance: 10 - 44 cm
- Screen sizes: 50" - 100"
- Throw ratio: 0,321
- Wall colour correction
- 3D technology: converts 2D in 3D, supports all 3D modes
- Projection modes: front, rear, front ceiling, rear ceiling

Connection

- Connectivity: 1x front Standard USB, 2x back HDMI, 1 front HDMI, 2x back Standard USB, Audio out (analogue, digital), Headphone out front, Standard SD card, VGA, Composite
- Wi-Fi: DLNA, Dualband 2.4GHz and 5GHz, Miracast, WLAN IEEE 802.11 b/g/n
- Bluetooth: Stream music from smartphone or tablet to Screeneo via Bluetooth

Sound

- Internal stereo speaker: 2 + subwoofer
- RMS: Output power 26 Watt
- Sound system: Dolby Digital 2.1
- Supported audio formats: mp3, wav

Supported video standards

- 1080i/p
- 480i/p

- 576i/p
- 720i/p
- NTSC
- PAL
- SECAM

Internal media player

- Supported audio formats: MP3, WAV
- Supported photo formats: JPEG, BMP, PNG, GIF
- Supported video formats: AVI, MOV, MP4, MKV, FLV, TS, M2TS, 3GP

Packaging dimensions

- Packed (W x D x H): 17.83 x 15.55 x 11.10 in / 453 x 395 x 282 mm
- Unpacked (W x D x H): 15.47 x 11.50 x 5.98 in / 339 x 292 x 152 mm

Power Supply

- Power adapter: 90-264V, 47-63Hz for EU and UK

Relative humidity

- Operation: 15-85% RH
- Storage packed: 5-93% RH
- Storage unpacked: 15-85% RH

Standard package includes

- 2xAAA battery
- Carrying bag
- DLP Link 3D Glasses
- HDMI cable
- Power cable
- Quick start guide
- Remote control
- User guide: on internal memory, internet
- HDP 1590

Temperature range

- Operation: 5-35 °C / 41-95 °F
- Storage packed: -25-60 °C / -13-140 °F
- Storage unpacked: 0-45 °C / 32-113 °F



Issue date 2014-11-06

Version: 3.0.1

12 NC: 8670 001 19659
UPC: 6 09585 24423 8

© 2014 Koninklijke Philips N.V.
All Rights reserved.

Specifications are subject to change without notice.
Trademarks are the property of Koninklijke Philips N.V.
or their respective owners.

www.philips.com